

FUJITEC

ZEXIA^m
Passenger Elevator with Machine Room

Permanent Magnet Gearless Traction Machine

The gearless traction machine with permanent magnet synchronous motor assure high riding comfort quality and low power consumption. This newly adopted technology reduces the weight and size of a traction machine, because gears are no longer required for elevator speed control.

Ultra - Slim Door Operator with Permanent Magnetic Synchronous Motor

Fujitec's new ultra-slim PM door operator employs Fujitec's highly-developed transmission mechanism which uses a PM motor as the driving device. Compared with conventional motor driving door operators, around 35% reduction in energy usage is achieved.

With multiple security settings, the adoption of a terminal holding device provides more stable, smooth opening and closing actions, ensuring safe elevator operation. In addition, the ultra-slim design saves hoistway space.



Distributed Control System

Serial communication is adopted between the control panel (32-bit), hall-call buttons and floor indicators.

Depending on content and quantity of data, multiple protocol is respectively used, which achieves high-speed and large-scale data communications as 10 times the rate when compared to conventional systems. As a result, the capability of monitoring elevator running status and instructions, with respect to communication speed, precision, reliability, has been greatly enhanced.

The "BUS LINE mode", advanced in the industry, is employed for communication, with strong anti-interference capabilities and multiple system expansion options.

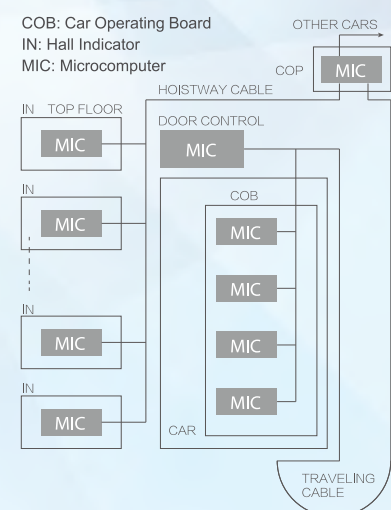

Instructions for conventional elevators are transmitted from the control panel in the machine room to respective devices through the traveling cable.

Fujitec's "distributed control system" will exert the advantage of its security much better, the respective functions will be implemented strictly through the correct command received, so the elevator will obtain the absolute security.

IONFUL - Plasmacluster Ion Generating device

Fujitec is the first elevator company to have installed a Plasmacluster Ion Generating device in an elevator. This device built in a car's ventilation unit disinfects airborne mold, bacteria, viruses, allergens and odor molecules as well as creating clean air in the elevator which enhances passenger comfort.

Structure of the plasmacluster ion generator

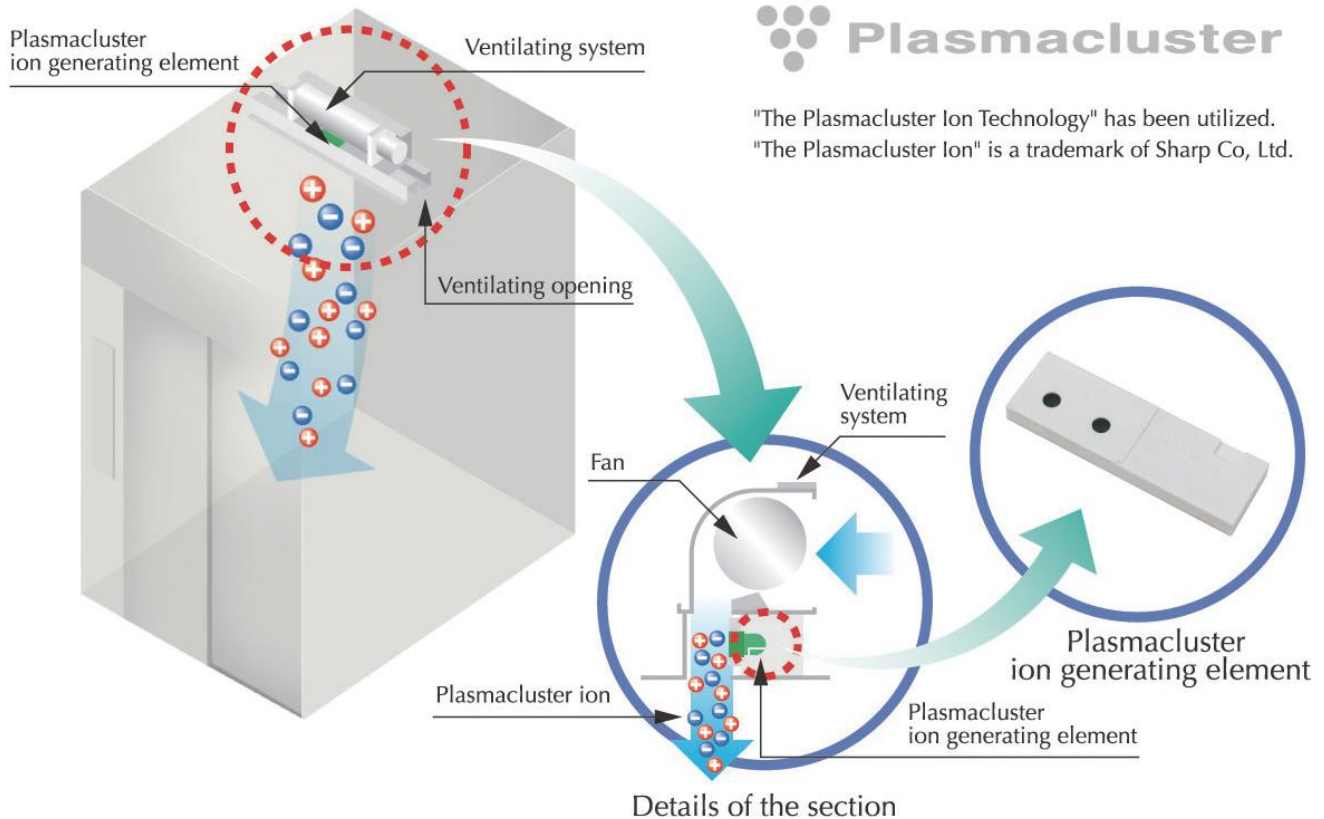

Multi-Beam Sensor

"Photoelectric Multi Beam Door Sensor" to prevent passenger or objects from being hit by the closing door.

The Sensor radiates infrared beams on almost the entire entrance area and draws an invisible beam curtain. When any of the beam is blocked, the closing door will stop and re-open. The multi-beam sensor enhances the detection of a person or an object when the doors are closing.



Standard Design

Metallica



Ceiling	Model No. CT- INM02 STAINLESS STEEL with LED Lights
Car Wall, Transom Car Door Return Panel (Integrated with entrance Column	Stainless Steel
Flooring	Studded Rubber / 25 mm recess / Vinyl Tile
Sill	Extruded Hard Aluminum
Ventilation	Cross Flow Fan
Handrail	CPH - GCO1 (Optional)

Classic



Ceiling	Model No. CT- INM01 PAINTED with LED Lights
Car Wall, Transom Car Door Return Panel (Integrated with entrance Column	Painted Steel Sheet (Colour Code - Non Metallic)
Flooring	Studded Rubber / 25 mm recess / Vinyl Tile
Sill	Extruded Hard Aluminum
Ventilation	Cross Flow Fan
Handrail	CPH - GCO1 (Optional)

Cabin Colour Guide

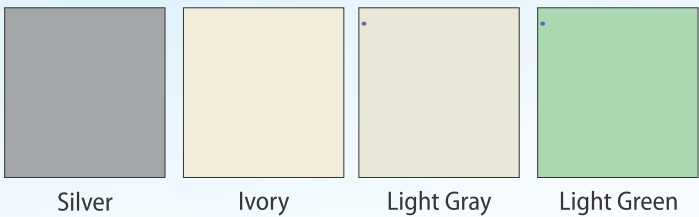

Flooring

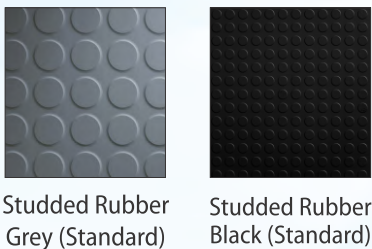

*Actual colour may vary from the colour shown in the pictures above.

Fixture Design

Car Fixture



Landing Fixture



Button



CP- D3

Button	Type	Surface Mounted Type
	Face Plate	Hairline Stainless Steel
	Indicator	Dot Matrix LED
	Model No.	CP- D3
	Type	Micro Push Button
	Button Head	Stainless Steel
	Illumination	Outer Ring
	Lighting Colour	Orange
	Braille	Standard
	Shape	Round

Handrail

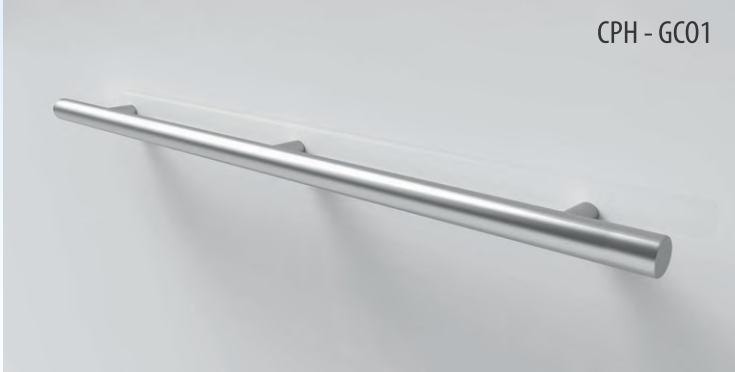

CPH - GC01

Car Ceiling Design



Stainless Steel



White

Ceiling Colour Guide



White

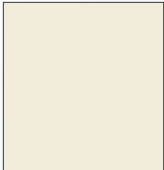

Ivory

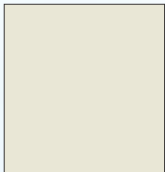

Light Gray

*Actual colour may vary from the colour shown in the pictures above.

Entrance Design



Narrow Jamb	ETT-18CC
Jamb	Painted Steel Sheet Optional : Stainless Steel
Doors	Painted Steel Sheet Optional : Stainless Steel
Sill	Extruded Hard Aluminium

Main Specifications

Items	Standard Spec.	Optional Spec.
Use	Passenger	
Driving Type	VVVF Drive	
Machine Room	With	
Speed	1 (m/s)	
Capacity	6P (408 kg), 8P (544 kg), 10P (680 kg), 13P (884 kg), 15P (1020 kg)	
Travel	Upto 21m	Upto 45m
Stops	2 ~ 8	9 ~ 16
Door	i) Door Type	2CO, 2SL
	ii) Door Control	PMDD Door Motor

Car Size Table

Capacity	No. of passengers	Speed m/ min	Cabin size (w x d) mm	Pit Depth mm	Overhead mm	Door Type	Opening Size (w x h) mm	Top Ceiling height mm	Minimum Hoistway Size (w x d) mm**	Machine Room size Min Height mm
408	6P	60	950 x 1150 *	1500	4000 ***	2SL	700 x 2000	2200	1425 x 1500	2200
			950 x 1150 *			2CO	700 x 2000		1600 x 1475	
544	8P		1050 x 1300 *			2SL	800 x 2000		1525 x 1650	
			1300 x 1100			2SL	800 x 2000		1775 x 1500	
			1050 x 1300 *			2CO	700 x 2000 *		1600 x 1600	
			1300 x 1100			2CO	800 x 2000 *		1800 x 1475	
680	10P		1300 x 1350			2CO	800 x 2000 *		1875 x 1650	
			1200 x 1400			2CO	800 x 2000 *		1800 x 1700	
			1100 x 1600			2CO	800 x 2000 *		1800 x 1900	
			1100 x 1600			2SL	800 x 2000		1675 x 1975	
884	13P		1600 x 1350			2CO	900 x 2000*		2175 x 1650	
			1100 x 2000			2CO	800 x 2000*		1800 x 2300	
			1100 x 2000			2SL	900 x 2000		1675 x 2375	
1020	15P		1600 x 1500			2CO	900 x 2000*		2175 x 1800	
			1200 x 2000			2CO	800 x 2000*		1800 x 2300	
			1200 x 2000			2SL	900 x 2000		1775 x 2375	

* With Door Offset

** Dimension Tolerance Of Hoistway shall Be +25mm / -0mm After Plastering.

*** Local Code Requirement to consider

Operation & Functional Specifications

Items	Items	Standard Spec.	Optional Spec.
Safety Functions	LANDIC (Battery Power Auto. landing Op.)	--	◆
	Emergency Power Operation (Generator Backup)	--	◆ (With individual GEN-SET backup)
	Fire Alarm Operation	—	◆
	Fireman operation	◆	--
	Emergency alarm device	◆	--
	Emergency Backup Power Supply	◆ (0.5 hour)	--
	Over-load protection	◆	--
	Advance door opening	--	◆
	Rescue Operation to Nearest Floor	◆	--
	Re-leveling operation	--	◆
	Door Opening Failure Rescue Operation	◆	--
	Open Door warning	--	◆
	Multi beam door protection (Without mechanical safety edge)	◆	--
	1 hour fire rated door	◆	--
Service Functions	Automatic Fan and Light control	◆	--
	Independent service	--	◆
	Attendant service operation	◆	--
	Reverse Direction Car- Call cancellation	--	◆
	Anti - Nuisance function	--	◆
	Mistaken Car- Call cancellation	◆	--
	Auto adjustment of door opening time	◆	--
	Door hold button (Door Open Hold Button)	--	◆
	Timer Controlled Parking operation	--	◆
	Door nudging	--	◆
	Automatic return to main floor	◆ 2 Car	◆ 1 Car
	Parking operation (Parking Switch Operation)	—	◆
	Car arrival chime	--	◆
	VONIC (Voice synthesizer)	--	◆
	Wiring for BGM Speaker on Car	--	◆
	CCTV Interface	--	◆
	Self check operation at night	◆	--
	Auto Bypass	--	◆
Security Functions	Restricted floor access operation (By coded floor call button)	--	◆
	Intercom	◆ CAR- CONTROLLER	◆ CAR - CONTROLLER - LOBBY

Layout

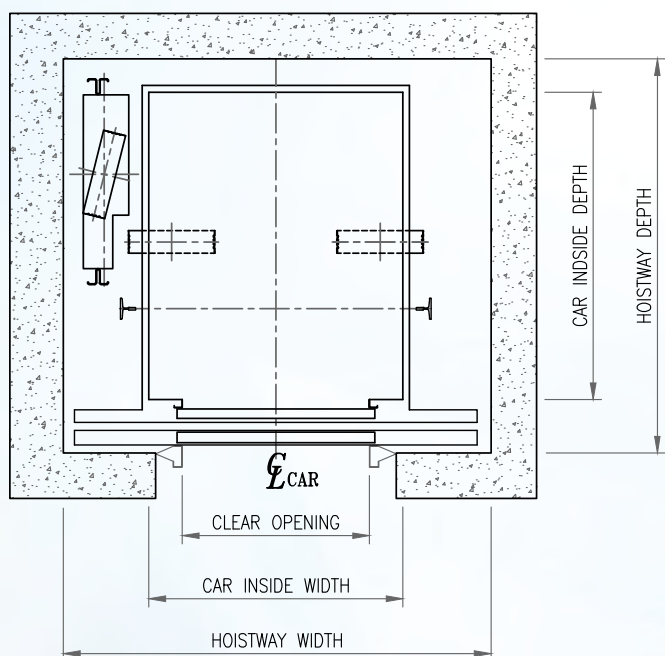

HOISTWAY PLAN
(CENTER OPENING)

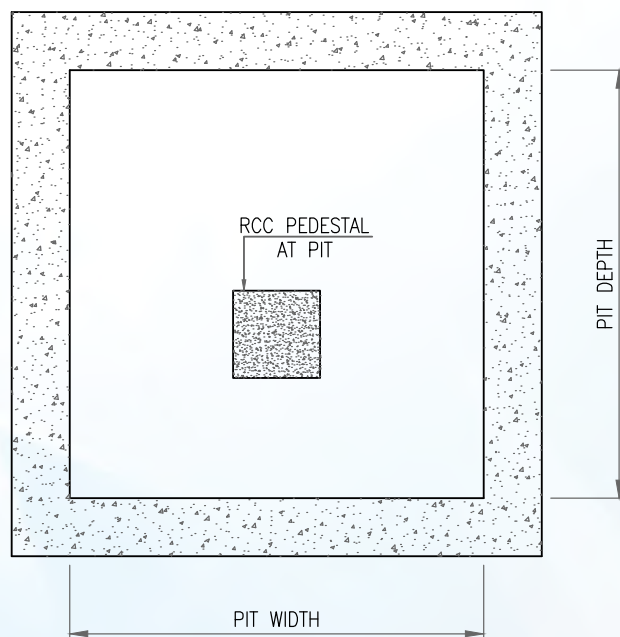

PIT PLAN

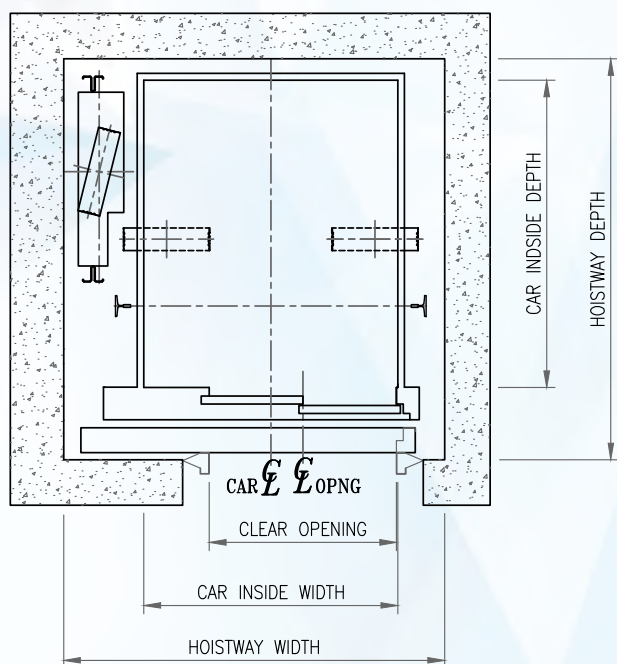

HOISTWAY PLAN
(LEFT SIDE OPENING)

CAPACITY (KG)	PIT REACTION (KG)	
	CAR (RC)	CWT (RW)
408	3700	3000
544	4650	3600
680	6900	5750
884	8100	6800
1020	8800	7250

Notes :

1. Dimension tolerance of hoistway shall be +25mm/-0mm after plastering
2. The hoistway internal dimensions are shown after plastering and pit water proofing finish
3. The pit depth specified is the minimum requirement. If it is larger than this, it needs to be filled up by the client
4. If the Hoistway dimensions are larger than the indicated maximum Hoistway size. It will be necessary to provide intermediate separator beams (by Client).
5. All shaft dimensions are taken over plaster.
6. The temperature of the elevator Hoistway should be below 40 °C
7. The provision of the main power and power for illumination in hoistway by laying of the feeder wiring from the electrical switch box in electrical room to the hoistway is to be done by client.
8. Voltage Fluctuation should be within range $\pm 7\%$

Layout

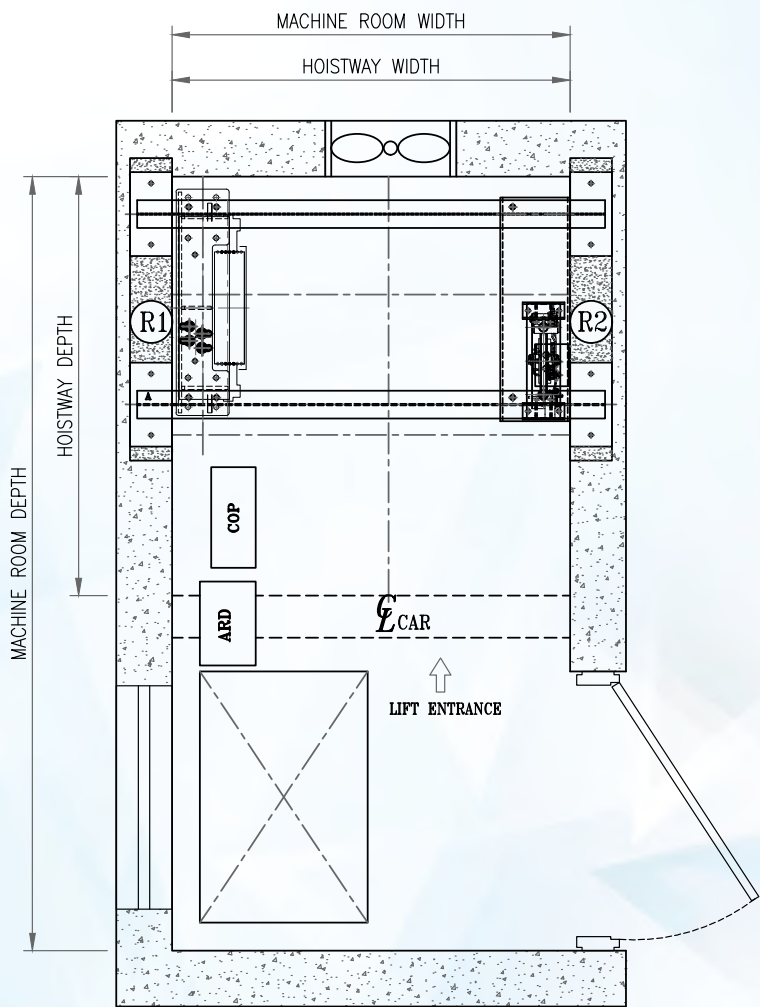
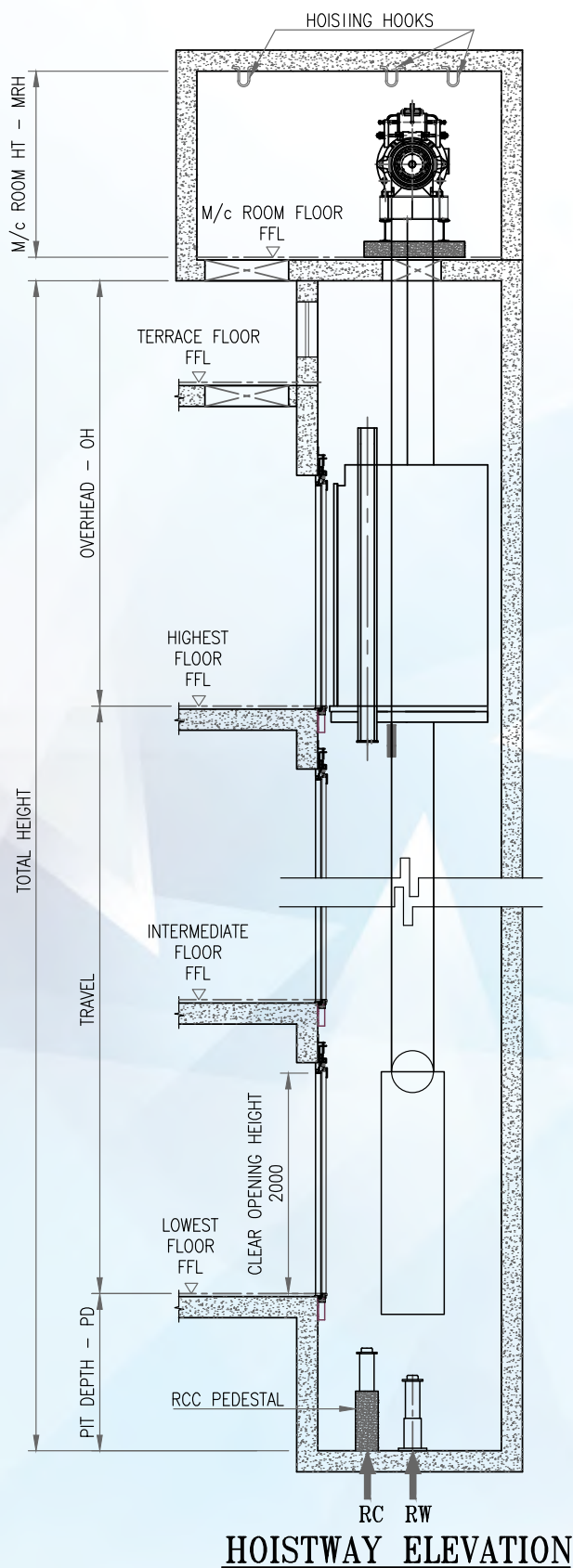

CAPACITY (KG)	M/c ROOM REACTION (KG)	
	R1	R2
408	3000	2000
544	3500	2200
680	4100	2700
884	4750	3200
1020	5000	3500



Fujitec Factory @ Chennai, India.

Factory & Corporate Office

Plot No. 52, First Cross Road, 8th Avenue,
Mahindra World City, Chengalpattu,
Kanchipuram Dist - 603002.
Tel : 044-47418800

Mumbai

B Wing-705, Kanakia Wall Street,
Andheri East, Mumbai – 400 093.
Tel : 022-28548246/47

Hyderabad

No.36, Flat No. 202,
Srinivasas Residency,
Sai Enclave 2nd Lane, Hubsiguda ,
Hyderabad - 500 007.
Tel : 040 - 42222280

Noida

Unit No.1041, B-Block, The Ithum
Sector 63 , Noida (U.P) - 201301
Tel : 0120-4180850

Chennai

No. 5, Cross Street, Srinagar Colony,
Saidapet , Chennai - 600 015.
Tel : 044 - 43123659

Navi Mumbai

Unit No. 201, Plot No. 61, Sector 11,
Raheja Arcade, C B D Belapur,
Navi Mumbai, Maharashtra - 400 614, India
Tel : 022-49726122

Gurgaon

Unit Num : 219 , Second Floor ,
Vipul Business Park , Sector-48
Sohna Road , Gurgaon - 122018
(Haryana)
Tel : 0124 - 4301410 / 11

Pune

Office No. 111, 1st floor,
Platinum Square, Survey No. 30,
Beside Hyatt Hotel,
Vimannagar, Pune - 411014.
Tel : 91-7875128123

Bangalore

No.20, 2nd & 3rd Floor, Lakeview Manor,
Narayan Reddy Colony,
Annaswamy Mudaliar Road,
Ulsoor, Bangalore – 560 042.
Tel : 080-42693999

Cochin

3rd Floor, Darussalam Building,
66/343, Near YMCA, Chittoor Road,
Behind Kandam Kulathi Ayurveda Hospital,
Ernakulum - 682035.
Tel : 8129711799

Delhi

Tower Plot, Unit No-624,
6th Floor, District Center,
West End Mall,
Janakpuri, New Delhi - 110058

Trivandrum

Door No. 210, First Floor,
Anna's Arcade, Spencer Junction,
MG Road, Thiruvananthapuram,
Kerala -695001.
Tel : 8129711799

Enquiries from other areas contact sales@fujitecindia.com

FUJITEC

www.fujitecindia.com